



## → **PET FOOD SOLUTIONS**

*ACMI'S SOLUTIONS FOR THE PET FOOD SECTOR*

- 1984 → YEAR OF FOUNDATION (PARMA, ITALY)
- 4 → BRANCHES: USA, UK, MEXICO, POLAND
- 5 → PRODUCTION PLANTS IN THE PROVINCE OF PARMA
- 10 → SERVICE CENTRES
- 140 → COMPLETE LINES INSTALLED IN THE LAST 5 YEARS
- 400 → EMPLOYEES, INCLUDING BRANCHES

- 37 YEARS OF EXPERIENCE IN THE CONSTRUCTION OF PACKAGING MACHINES AND SYSTEMS
- ABILITY TO MANAGE SIMPLE AND COMPLEX PROJECTS AS A «LINE INTEGRATOR»
- PROVEN EXPERIENCE IN THE FOOD & BEVERAGE, MILK & DAIRY AND PET FOOD SECTORS
- COMPLETE RANGE OF MACHINES AND ROBOTIC SOLUTIONS FOR THE END OF LINE DEDICATED TO THE PET FOOD SECTOR

- "TAILOR-MADE« SOLUTIONS
- CUTTING-EDGE TECHNOLOGY
- TRAINING, PREDICTIVE MAINTENANCE, CONTINUOUS IMPROVEMENT
- WIDE USE OF ROBOTIC SOLUTIONS
- ABILITY TO MANAGE COMPLEX PROJECTS
- NUMEROUS INSTALLATIONS IN OPERATION
- FLEXIBILITY AND INNOVATION
- LINE CERTIFICATION AND RISK ANALYSIS
- INDUSTRY 4.0 COMPLIANT

100

TOTAL NUMBER OF INSTALLATIONS IN THE FOOD AND PET FOOD SECTOR (SINGLE MACHINES AND COMPLETE LINES)

1991

YEAR OF THE FIRST INSTALLATION IN THE FOOD SECTOR

2017

YEAR OF THE FIRST INSTALLATION IN THE PET FOOD SECTOR



AN EXAMPLE OF A PET FOOD END OF LINE DESIGNED BY ACMI

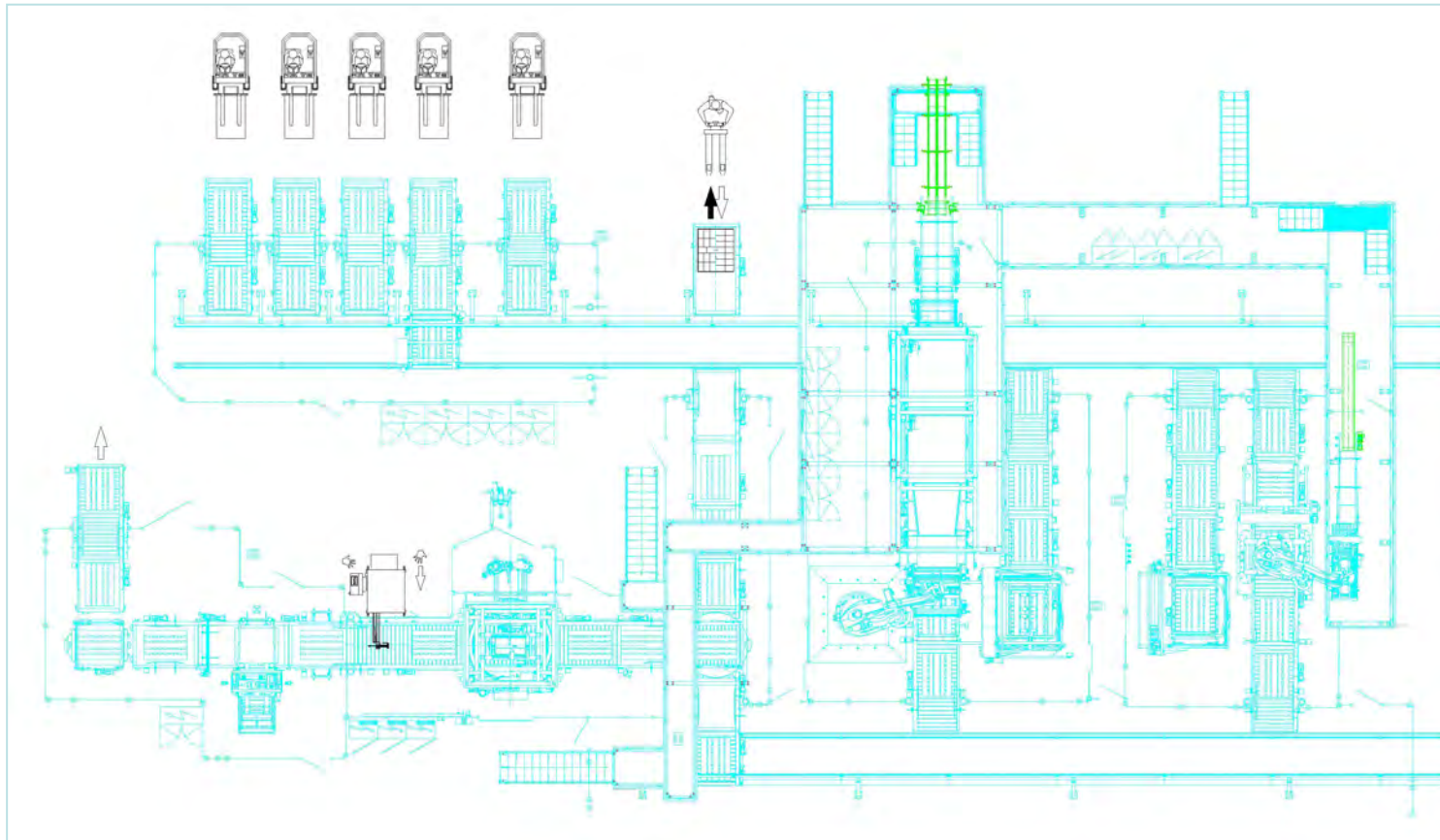



ACMI MAKES WIDE USE OF ROBOTIC APPLICATIONS TO OBTAIN THE FOLLOWING ADVANTAGES:

- DELICACY IN HANDLING THE PRODUCT
- EXCELLENT ACCESSIBILITY AND ERGONOMICS
- BETTER SAFETY CONDITIONS FOR THE OPERATOR
- VERSATILITY
- VERY LOW MAINTENANCE COSTS
- QUICK AND EASY FORMAT CHANGEOVER OPERATIONS
- AUTOMATIC GRIPPING HEAD CHANGEOVER
- HIGH RELIABILITY, LOW MAINTENANCE COSTS, LOW ENERGY CONSUMPTION



ACMI'S REPACKING LINES ARE ALSO PARTICULARLY SUITABLE FOR THE PET FOOD SECTOR:

- THESE ARE FLEXIBLE, HIGHLY PERSONALISABLE SOLUTIONS
- DIFFERENT DEGREES OF AUTOMATION AND MODULARITY
- REDUCTION OF MANUAL OPERATIONS, GREATER SAFETY AND PRODUCTIVITY
- THEY ARE SYSTEMS WITH PROPRIETARY ACMI TECHNOLOGY
- CONFIGURATION EXAMPLES:
  - RAINBOW PALLET FOR PACKS (PALLET WITH A MIX OF PACKS OF DIFFERENT FLAVOURS)
  - RAINBOW MULTIPACK (A MIX OF PACKS OF DIFFERENT FLAVOURS ON A TRAY/CARTON)



DOUBLE PET FOOD END OF LINE, POLAND

FORMATS: BAG-IN-BOX IN CARTONS

SPEED: 54,000 BPH – 70,000 BPH (1.700 CARTONS/HR)

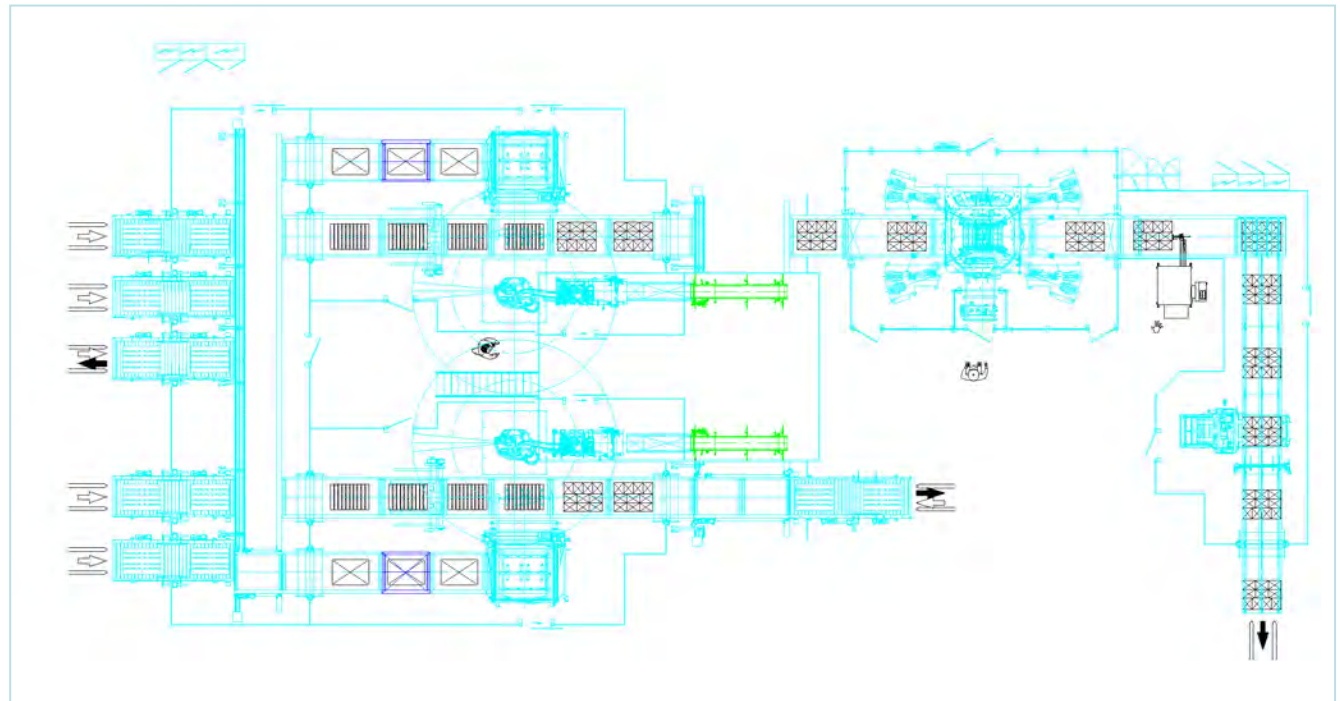

DOUBLE PET FOOD END OF LINE, USA  
FORMATS: CANS ON TRAYS/CANS ON CARTONS  
SPEED: 10,000 CARTONS/HR

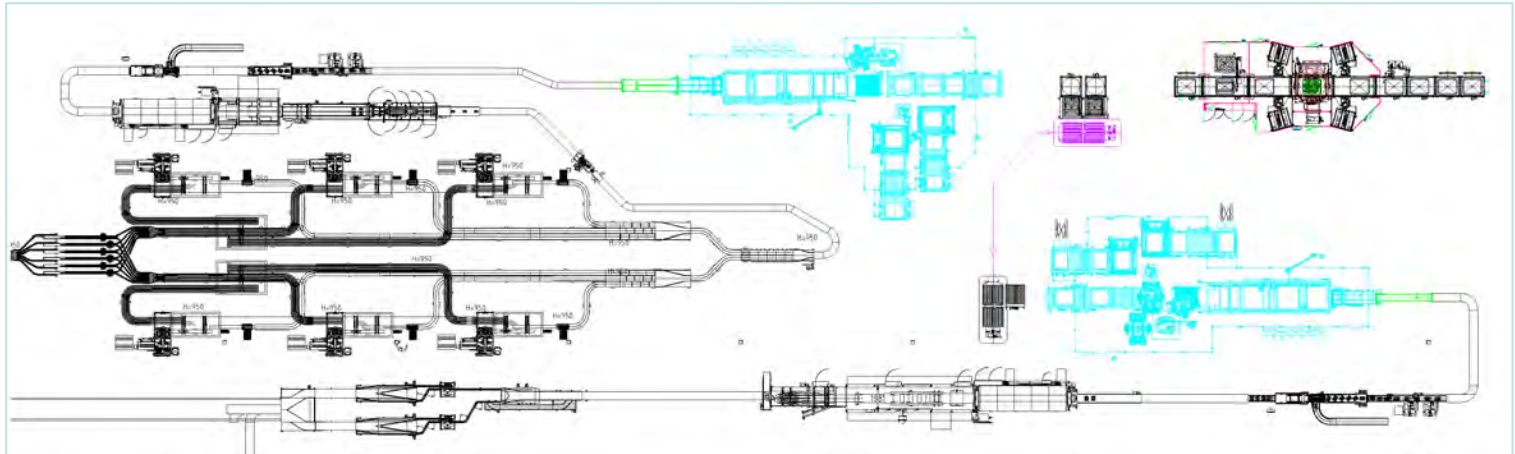

DOUBLE PET FOOD END OF LINE (HANDLES 4 LINES), RUSSIA  
FORMATS: BAG-IN-BOX IN CARTONS  
SPEED: 2,000 CARTONS/HR

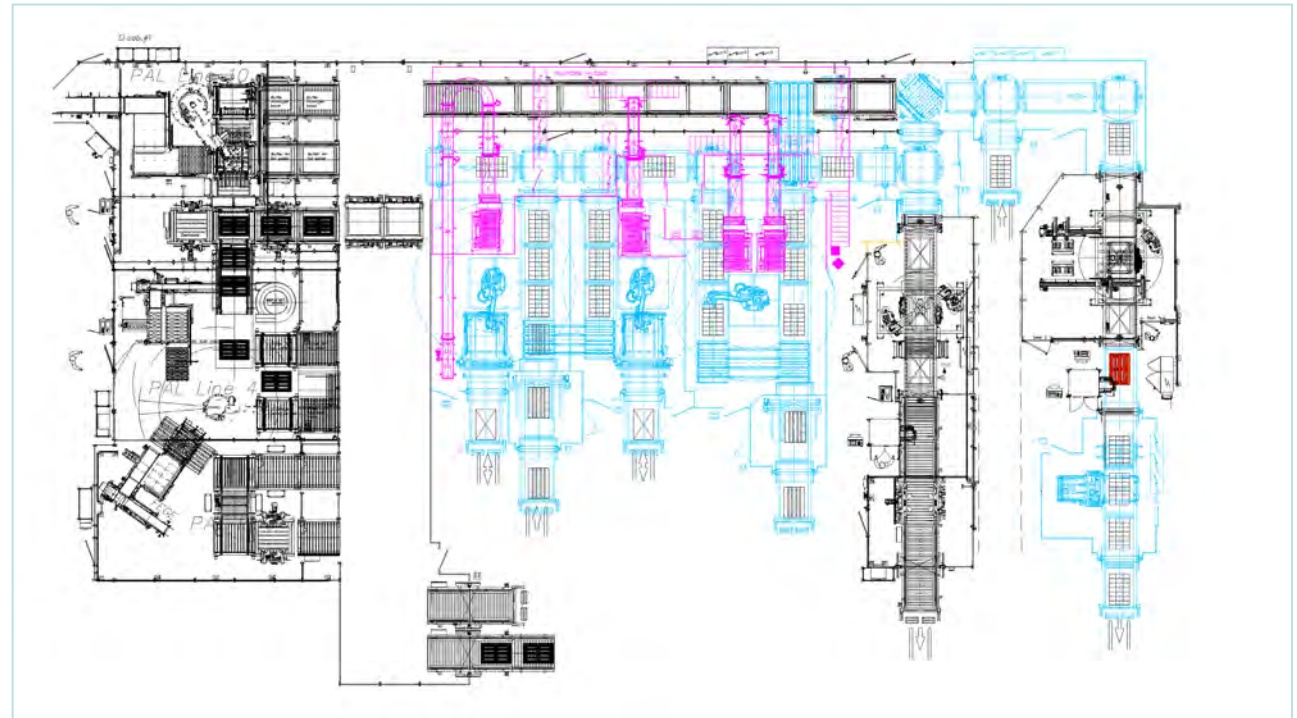

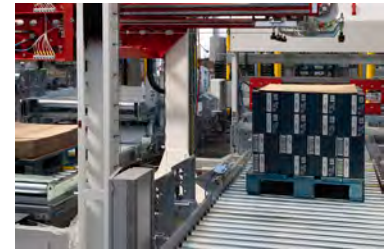

ACMI S.p.A.  
Via G. Di Vittorio, 60  
Fornovo Taro (PR), ITALY  
T. +39 0525 401811  
info@acmispa.com  
www.acmispa.com

